

- SPEC :
- Housing: High-Temp Plastic, UL94-V  
Color: Black
  - Locker: High-Temp Plastic, UL94-V  
Color: Black
  - Contact: Phosphor Bronze  
Initial: 30m Ohms Max.  
Voltage Rating: 50V AC, DC
  - Solder Tab: BRASS
  - Temperature Rating: -25°C ~ +85°C
  - Dielectric Withstanding Voltage: 500V AC/Min

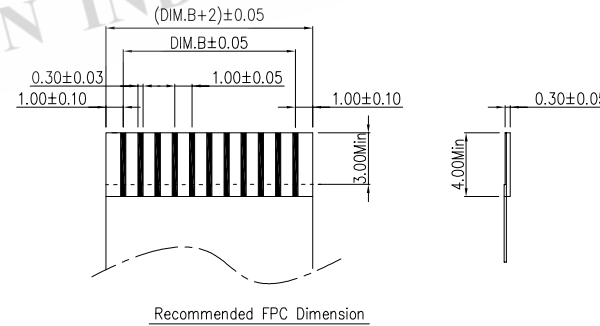

ORDERING INFORMATION:

FPCZ - 10200 PHCE - xx - x - x

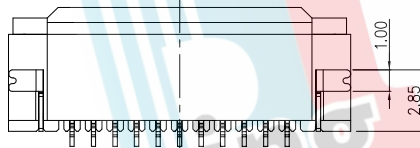
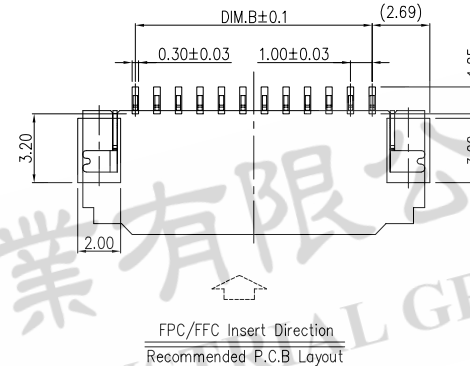
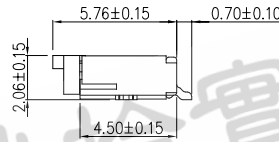
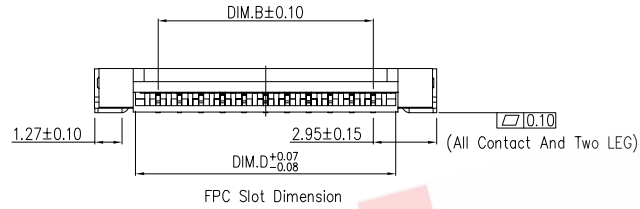
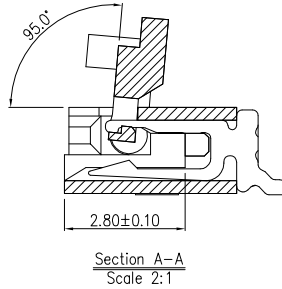
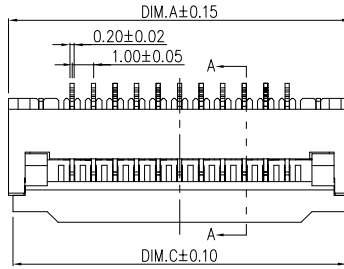
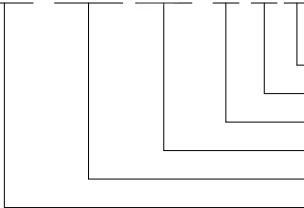

- PLATING: T=TIN G=GOLD FLASH
- PACKING T=TUBE R=REEL
- NO. of contacts
- Series name
- PITCH=1.0mm
- FPC SERIES



**鼎掄實業有限公司**  
DINGLUN INDUSTRIAL CO., LTD.

TITLE

FPC 1.0PH 2.0H 掀蓋貼前插

DRAWN: *Michael Lin*  
2017/07/22

TOLERANCE SCALE  
.X ± 0.30 None

P/N NO.

FPCZ-10200PHCE-xx-xx

CHECKED: *Eddie Liu*  
2017/07/22

UNIT  
.XXX ± 0.10 mm

DWG. NO.

APPROVED: *Eddie Liu*  
2017/07/23

PROJECTION REV.  
A

CUSTOMER P/N NO.

REV.	REASONS	DATE	DRAWN
1			
2			
3			
4			
5			
6			
7			
8			
9			

● : 表示現有可提供PIN數

PIN	DIM.A	DIM.B	DIM.C	DIM.D
4	8.90	3.00	8.50	5.10
5	9.90	4.00	9.50	6.10
6	10.90	5.00	10.50	7.10
7	11.90	6.00	11.50	8.10
8	12.90	7.00	12.50	9.10
9	13.90	8.00	13.50	10.10
10	14.90	9.00	14.50	11.10
11	15.90	10.00	15.50	12.10
12	16.90	11.00	16.50	13.10
13	17.90	12.00	17.50	14.10
14	18.90	13.00	18.50	15.10
15	19.90	14.00	19.50	16.10
16	20.90	15.00	20.50	17.10
17	21.90	16.00	21.50	18.10
18	22.90	17.00	22.50	19.10
19	23.90	18.00	23.50	20.10
20	24.90	19.00	24.50	21.10
21	25.90	20.00	25.50	22.10
22	26.90	21.00	26.50	23.10
23	27.90	22.00	27.50	24.10
24	28.90	23.00	28.50	25.10
25	29.90	24.00	29.50	26.10
26	30.90	25.00	30.50	27.10
27	31.90	26.00	31.50	28.10
28	32.90	27.00	32.50	29.10
29	33.90	28.00	33.50	30.10
30	34.90	29.00	34.50	31.10
31	35.90	30.00	35.50	32.10
32	36.90	31.00	36.50	33.10